

A silhouette of a city skyline against a sunset sky. The sky transitions from a deep orange at the top to a bright yellow near the horizon. The skyline includes several buildings of varying heights and shapes, with the most prominent one on the left being a tall, thin tower with a circular observation deck. The sun is visible on the right side of the horizon, partially obscured by a building.

Manufacturers of innovative  
visual communication solutions  
for the sign and display industries.

# CLIP-IN SIGN FRAME

Simple to install, simple to exchange signs



## FEATURES AND BENEFITS

- Endless applications
- Any rigid sign material can be used
- Load signs from any side
- Easy to change signs



**OUTSIDE DIMENSIONS ONLY 1" LARGER  
THAN INSERT DIMENSIONS  
(HEIGHT AND LENGTH)**

## CLIP-IN EXTRUSIONS:

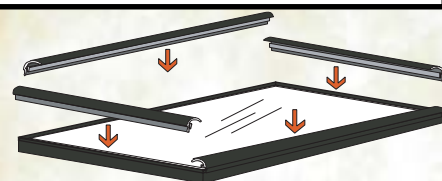
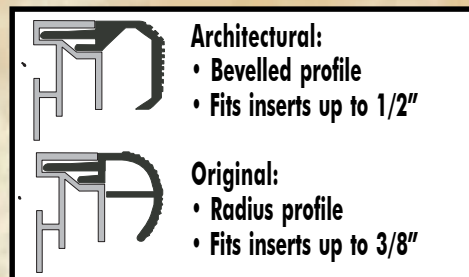

Sign can be loaded from any side.

These frames can be used with any rigid sign substrate: wood, plastic, metal, etc. Extruded aluminium construction ensures a light, durable, quality product, available in black painted or clear satin anodized finishes. The Clip-in frame is easy to mount / install, exchange signs. Its slim serrated profile makes it fit within any commercial, industrial or retail environment. Perfect for displaying signs indoors and/or outdoors.

\*Front covers and backing panels supplied only at customers request.



Mount / Install frame



Remove security screw to release frame



Insert sign



Re-install frame and security screw

# CLIP-IN LIGHT BOX.....

Custom built to your specifications  
**EXTRUDED ALUMINIUM CONSTRUCTION**

**SINGLE SIDED: 5 1/2" DEEP**  
**DOUBLE SIDED: 7 " DEEP**

**OUTSIDE DIMENSIONS**  
**ONLY 1" LARGER**  
**THAN INSERT DIMENSIONS**  
**(HEIGHT AND LENGTH)**



## CLIP-IN LIGHT BOX EXTRUSION:



Original:  
 • Radius profile  
 • Fits inserts up to 3/8"

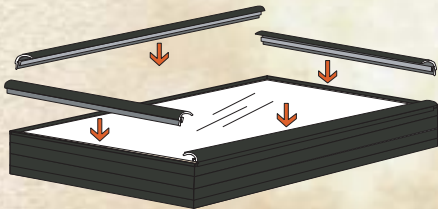

Insert can be loaded from any side

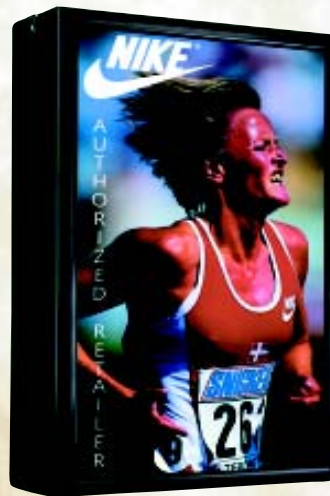

**PERFECT FOR**  
**ILLUMINATING**  
**SIGNS, POSTERS AND**  
**TRANSPARENCIES**



The Clip-in illuminated light box is available in five stock sizes. Our original aluminium extrusion design allows for construction of custom sized boxes, single or double sided in order to meet your advertising requirements. Custom light boxes can be ordered in both black painted or clear satin anodized finishes. Used with signs or transparencies etc. the Clip-in box illuminates the selected media with smooth, even light. Simply add graphics and slide insert in.

\*Inserts available, only at customers request.

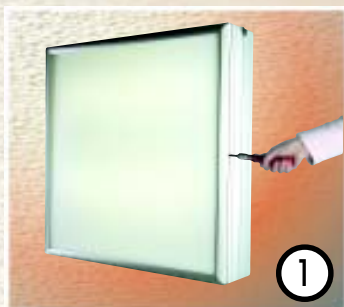

Remove security screw to release frame

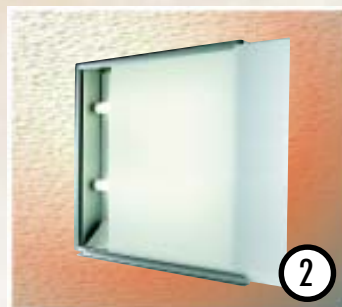

Remove insert and apply graphics



Replace insert



Re-install frame and security screw

# SNAP FRAME SYSTEM

• NON-ILLUMINATED •

Exchange graphics in a "SNAP"

## EXTRUDED ALUMINIUM CONSTRUCTION

OUTSIDE DIMENSIONS  
ONLY 2 1/4" LARGER  
THAN INSERT DIMENSIONS  
(HEIGHT AND LENGTH)

PERFECT FOR  
DISPLAYING  
SIGNS, POSTERS AND  
TRANSPARENCIES.

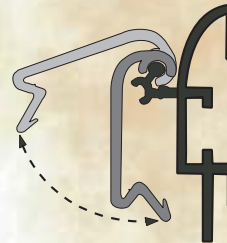
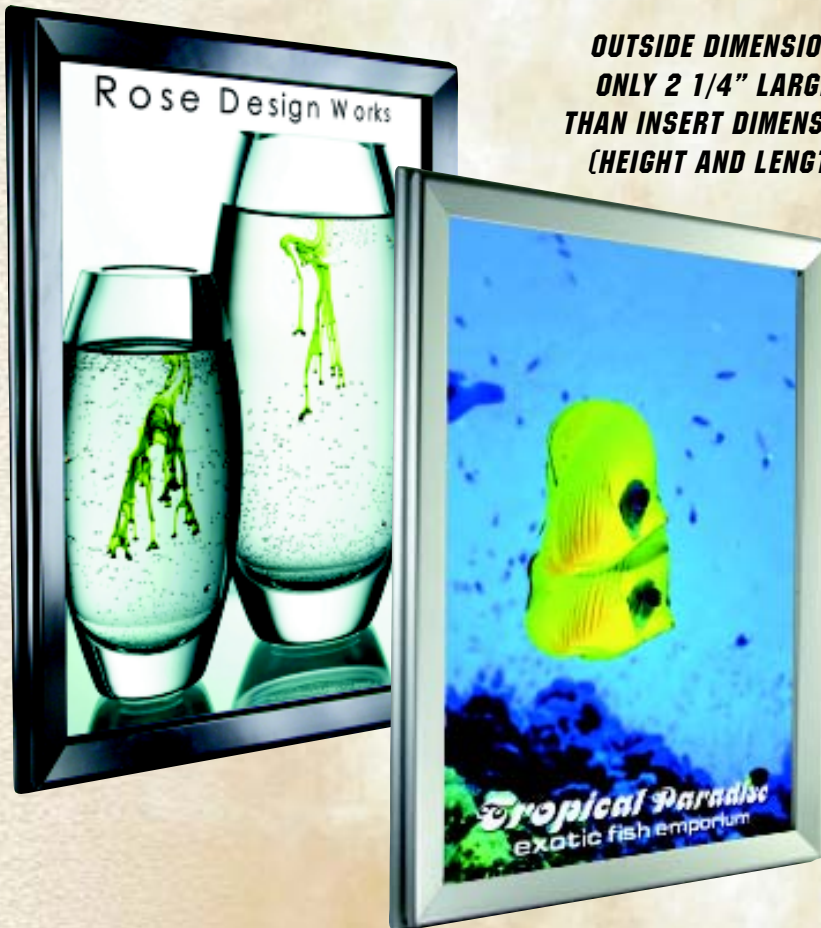

Profile of the Snap Frame

- Only 1" deep!
- Use any rigid insert material up to 1/4" thick

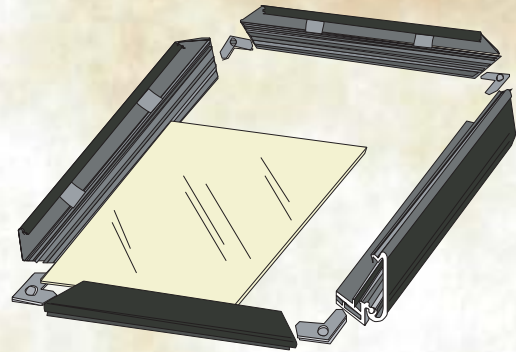

Units are shipped unassembled  
unless covers and backings are requested.  
Simply tighten 8 screws to assemble

The Snap Frame is the simplest, most user friendly solution for displaying graphics that need to be changed frequently. Made from extruded aluminium and available in black painted or clear satin anodized finishes. At only 1" deep this product creates an appealing slim and well finished look. Our manufacturing processes ensure construction that is custom made to your specifications each and every time you order. In a commercial, industrial or retail environment the Snap Frame communicates your message in style.

\*Front covers and backing panels are available at customers request.

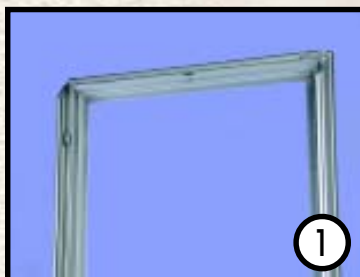

**SIMPLY OPEN SPRING LOADED SNAP FRAME ON EACH SIDE IN ORDER TO EXCHANGE GRAPHICS**

# SNAP FRAME LIGHT BOX.....

• ILLUMINATED •

Exchange graphics in a "SNAP"

## EXTRUDED ALUMINIUM CONSTRUCTION

## PERFECT FOR BACK LIGHTING SIGNS, POSTERS AND TRANSPARENCIES



### STANDARD FEATURES:

- Single or double sided
- Snap frame graphic holding system
- Extruded aluminium construction
- Black painted or clear satin anodized finishes
- Manufactured to your specifications
- Complete with lamps, wiring, and ballast (s)
- Just add graphics then plug in

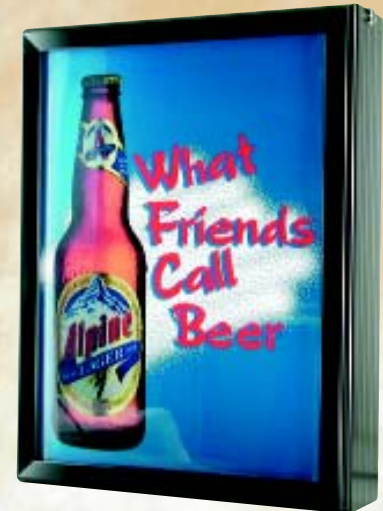

**SINGLE SIDED: 5 1/2" DEEP  
DOUBLE SIDED: 6 1/4" DEEP**

**OUTSIDE DIMENSIONS ONLY 2 1/4" LARGER  
THAN INSERT DIMENSIONS  
(HEIGHT AND LENGTH)**



The Snap Frame light box has quickly become one of our best selling items and boasts: easy operation, durability, versatility with sizing, no added parts or pieces needed to hold your graphics in place, smooth even light, and the prospect to generate sales and increase profits. Excellent for applications that require frequent graphic changes.

\*Inserts available only at customers request.



**SIMPLY OPEN SPRING LOADED SNAP FRAME ON EACH SIDE IN ORDER TO EXCHANGE GRAPHICS**

# LOCK-A-GRAPHIC SYSTEM

NON ILLUMINATED • 1 5/8" DEEP

Display your message safely under lock and key



**PERFECT FOR  
DISPLAYING  
SIGNS, POSTERS AND  
TRANSPARENCIES.**

## YOUR COMMUNITY BOARD



Insert  
in-door  
graphics or  
pin up your  
advertising  
onto a  
self-sealing  
natural  
cork  
board



### ADVERTISE WITH CONFIDENCE:

- Signs
- Community information boards
- Movie and theatre advertising
- Company / Product identification
- Employment / safety posters
- Menu displays
- Etc.

Makes a great encasement for reader boards and interchangeable letter boards.

**EXCLUSIVE** Snap frame door design allows for changes in a snap.

Equip your new building or update your current signage system with Lock-A-Graphic. Durable and stylish all aluminium extruded constructed frames available in one and two door models with or without built in sign header. The Lock itself boasts smooth operation and is supplied with two keys.

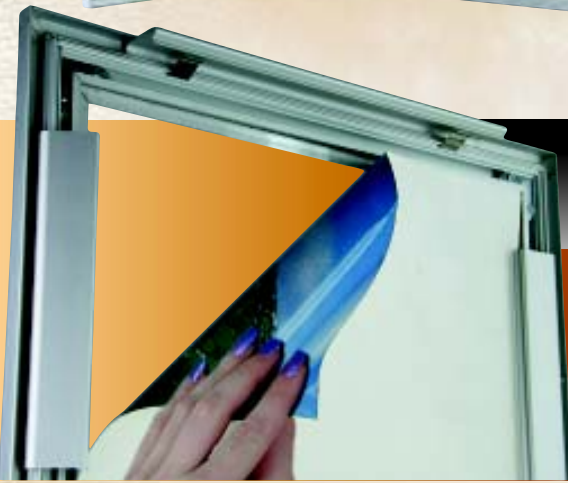

# LOCK-A-GRAPHIC SYSTEM.....

ILLUMINATED • 5 3/4" DEEP

Display your message safely under lock and key



**PERFECT FOR  
ILLUMINATING  
SIGNS, POSTERS AND  
TRANSPARENCIES.**



## STANDARD FEATURES:

- No external holders or magnetic strips
- All aluminium extruded construction
- Lockable door(s) with two keys
- Shatter resistant clear acrylic window
- Continuous piano hinges
- Black painted or clear satin anodized finishes
- Wall mounted or recessed
- Full range of custom sizes available



**EXCLUSIVE** Snap frame door design eliminates plastic defuser and allows for changes in a snap.

Prevent tampering and theft in high traffic areas, while providing a high impact, user friendly system for displaying signs, posters and transparencies, etc.



# MARQUEE SIGN SYSTEM

ILLUMINATED (BACK-LIT)

Movie and theatre advertising made easy

**IDEAL SYSTEM FOR  
MOVIE THEATRES,  
VIDEO RENTAL,  
SHOWS AND  
SPECIAL EVENTS**



### STANDARD FEATURES:

- Single or double sided
- Snap frame graphic holding system
- All extruded aluminium construction
- Black painted or clear satin anodized finishes
- Easy installation and maintenance
- Plastic diffuser
- Back lighting
- Flash lighting



**SINGLE SIDED 5 1/2" DEEP • DOUBLE SIDED 7 1/4" DEEP  
DURABLE EXTRUDED ALUMINIUM CONSTRUCTION**



With one of our Marquee signs in the window, any business is sure to attract attention. The stock size (37 1/2" x 50 1/2") is designed to illuminate movie type posters and transparencies with the added visual impact of flashing bulbs. Available in a double sided configuration it is possible to display graphics both inside and out, with the flash lighting facing one side. This system is a strong, durable, user friendly signage solution that illuminates the selected media with smooth even light and is very effective at reaching its intended target market.

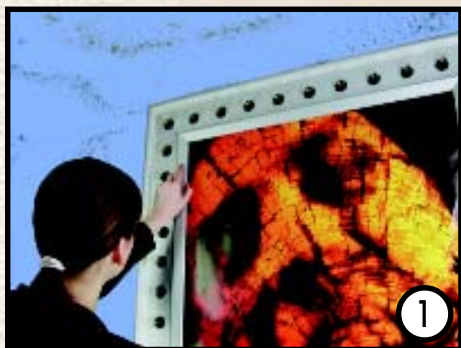

**SIMPLY OPEN SPRING LOADED SNAP FRAME ON EACH SIDE IN ORDER TO EXCHANGE GRAPHICS**



# SLIDE-IN DESIGN

Generate sales and increase profits

## EXTRUDED ALUMINUM ILLUMINATED BOXES

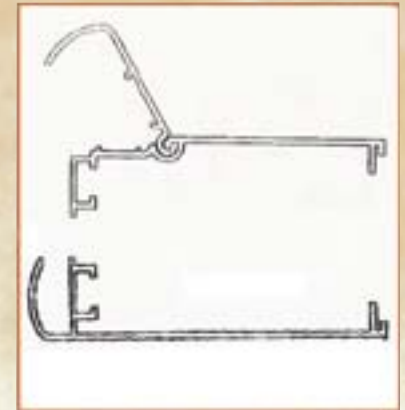

### STOCK SIZES

- \* 12" X 24" X 3.0"      24" X 36" X 5.0"
- \* 12" X 36" X 3.5"      24" X 48" X 5.0"
- \* 18" X 24" X 5.0"      36" X 48" X 5.0"
- \* 24" X 24" X 5.0"

\* Formed Steel Light Boxes



**CERTIFIED**



These stock illuminated boxes are designed for a budget minded customer. Hinged frame allows for easy, tool free installation of signs, posters and duratrans. Simply slide in graphic, and plug in.

In support of our in-stock product line, we offer custom manufactured steel light boxes that satisfy many parameters:

Shapes: Circular, rectangular, square, triangular, dome top, bowed face, corner box, etc.

Colours: Powder coating process allows many variations.

Application: As a part of a display, company/product identification, p.o.p., kiosk, wall mounted, recessed, etc..

Framing: Hinged sides, hinged frame (complete), single or double sided, tool free, lockable door, etc.

With minimum quantities as low as 50 units, we can work with you to design a line of products that will meet your visual, functional, and budgetary requirements.



1

Open hinged frame



2

Slide in the insert



3

Close hinged frame

# OUTDOOR SIGN CABINETS

Great performance for outdoor applications

## EXTRUDED ALUMINIUM CONSTRUCTION

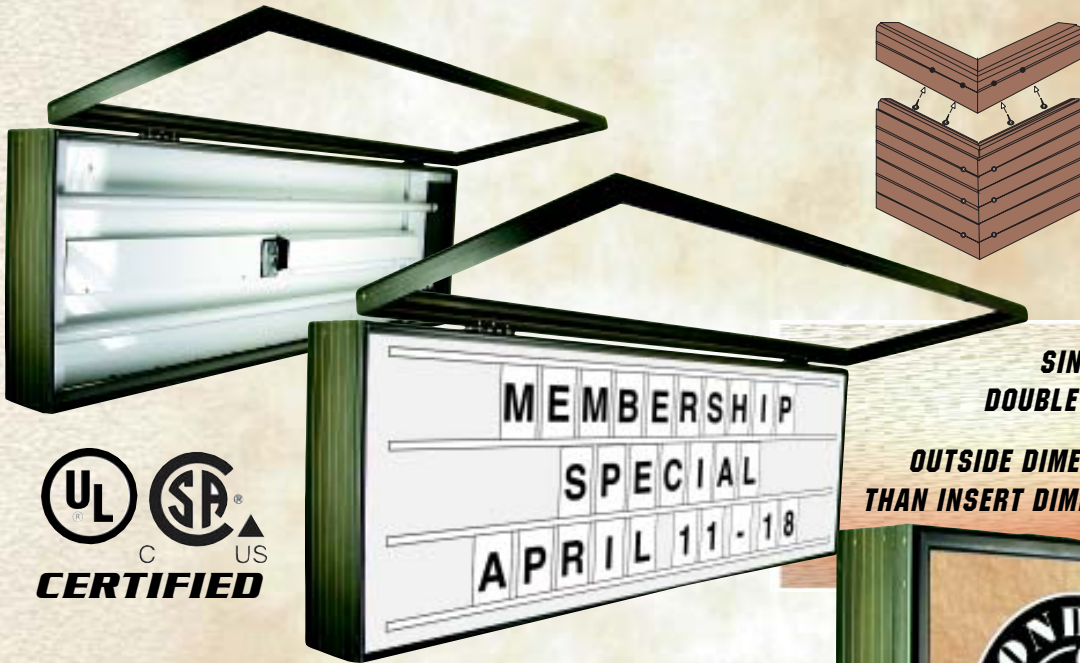

**SINGLE SIDED: 8" DEEP**  
**DOUBLE SIDED: 10" & 16" DEEP**  
**OUTSIDE DIMENSIONS ONLY 1/2" LARGER**  
**THAN INSERT DIMENSIONS (HEIGHT AND LENGTH)**

**EACH UNIT IS FULLY CONSTRUCTED AND ASSEMBLED TO YOUR SPECIFICATIONS. READY FOR GRAPHIC APPLICATION AND INSTALLATION**



### STANDARD FEATURES:

- Durable structural design, great outdoor performance
- Black or Bronze painted finishes
- One piece, seamless, hinged outer frame
- Can be built to accept 1 or 2 pieces of plastic per side
- Complete with lamps, ballast(s), and wiring

The exterior system is a strong, durable extruded aluminium outdoor signage solution boasting excellent outdoor performance. The solid, one piece outer frame holds signage substrates up to 1/4" thick and lifts up on hinges. Easily modified to be used with changeable letters and/or signs, this system compliments any commercial, retail or industrial environment, and provides a quality, well finished appearance, while illuminating the selected media with smooth, bright, even, light.



# SLIMBRIGHTS.....

• 2 1/2" DEEP BACKLIT LIGHT BOXES

Exchange graphics in a "SNAP"

**CUSTOM FABRICATED TO YOUR SPECIFIED SIZE**



- 2 1/2" DEEP  
BRIGHT  
BACK LIGHTING
- PERFECT FOR  
SIGNS, POSTERS AND  
TRANSPARENCIES



**CERTIFIED**

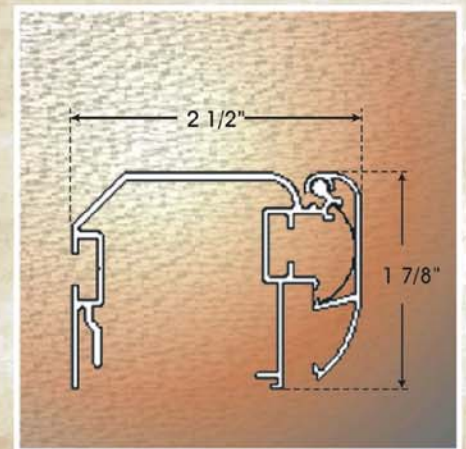

Snap frame system offers easy and convenient operation for changing graphics and routine maintenance.

Standard T-8 lamps and simple plexiglass faces eliminate the need for specialized components purchases.

Standard colors: black, clear anodized.

## STANDARD SIZES

18" X 27.75" X 2.5"

26" X 27.75" X 2.5"

26" X 39.75" X 2.5"

38" X 51.75" X 2.5"



**SIMPLY OPEN SPRING LOADED  
SNAP FRAME ON EACH SIDE  
IN ORDER TO EXCHANGE  
GRAPHICS**

# DURA-BRITE

Illuminated advertising displays

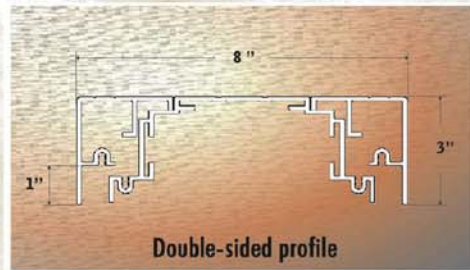

### STANDARD FEATURES:

- All aluminium extruded heavy duty construction
- Lockable door(s)
- Clear acrylic window(s)
- Translucent acrylic diffuser(s)
- Brite and even lighting
- Black painted
- Wall mounted—single sided or double sided bus shelter style
- Full range of custom sizes available



## EXCLUSIVE

Split magnetic hinge insures quick and easy changing of graphics while preventing wrinkling and light leakage.

Minimize vandalism and reduce service requirements



# METAL SIGN HOLDERS.....

Easy to use with various signage materials



## WINDSPINNER

Total height: 39"  
DISPLAY AREA:  
18" X 30"

W-1836

Spins with ease.  
Heavy duty 30" (diagonal) secure base.  
Solid steel construction, can be used with a variety of substrates up to 1/2" thick (not included).  
Pegs sold separately.

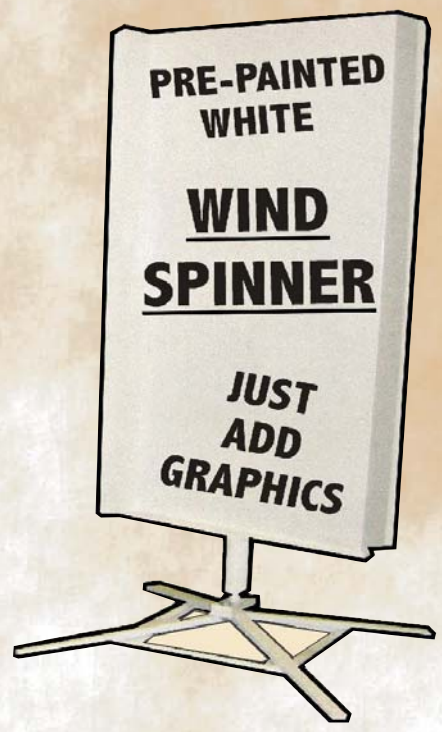

18" X 36"  
DISPLAY AREA

SOLID STEEL  
CONSTRUCTION

SPINS WITH  
EASE

W-1836W

In addition to our extensive range of "A" frame type sign holders we also offer a line of products that are equally easy to use and support the same range of possible insert materials, and are designed to produce a high impact effect. Inserts are available at the customers request.



Adjustable  
Double Sided  
or Single Sided  
**BANNER STAND**

Height Adjusts  
from 35"  
to 68"

BNF-60



USE UP TO 36" BANNERS  
(24" or 36" banner arms available)



**CHROME FLOOR STAND**  
Heavy 16" (D) base  
Total height: 65"

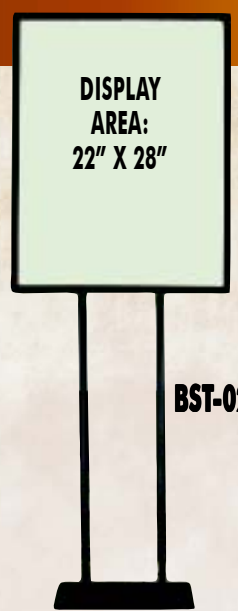

**BLACK FLOOR STAND**  
Total height: 60"

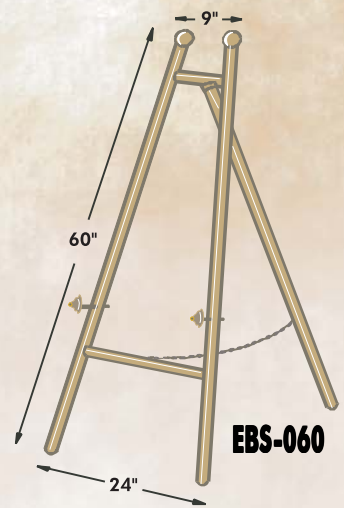

**BRASS COLOURED EASEL**

# METAL SIGN HOLDERS.....

Easy to use with various signage materials

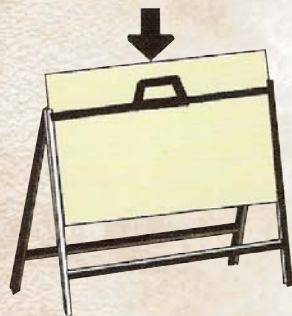

**A-218:** Insert size: 24" X 18"  
**A-232:** Insert size: 32" X 24"  
 Top loading

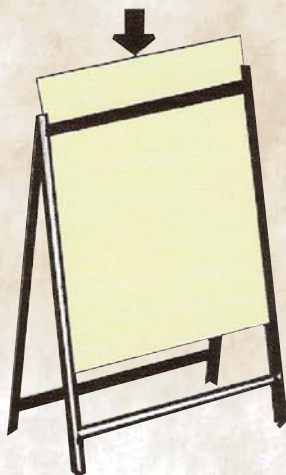

**A-203:** Insert size: 24" X 36"  
 Top loading

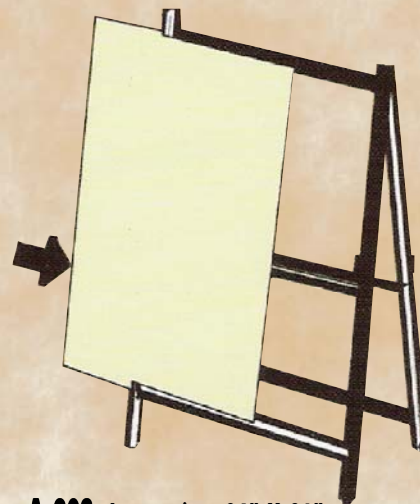

**A-203:** Insert size: 24" X 36"  
**A-204:** Insert size: 24" X 48"  
**A-324:** Insert size: 32" X 48"  
 Side loading



There are many metal sign holders to choose from. Each one is an engaging solution which presents the respective signage in a durable, sturdy "A" frame constructed out of steel with black powder coated finish. These frames support many different display area requirements and materials; plywood, masonite, aluminium, coroplast, plastics, etc. Very easy to use and maintain, simply paint or apply vinyl graphics to the insert and slide it in.

\* Inserts available, only at customers request

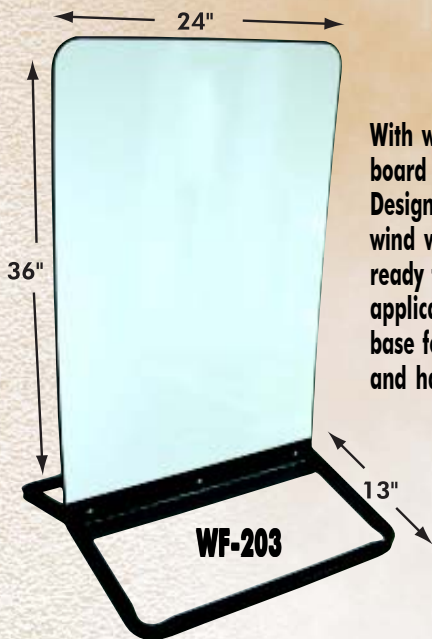

## WINDFLEX

With white aluminium board .  
 Designed to flex in the wind without breaking, ready for paint or vinyl application. Folding base for easy storage and handling.

**WF-203**

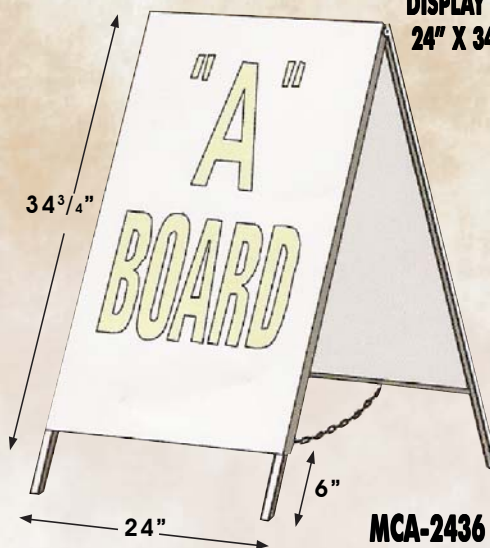

**"A" BOARD  
 DISPLAY AREA:  
 24" X 34 3/4"**

**MCA-2436**

Steel construction, painted white. No additional inserts required. Just add graphics.

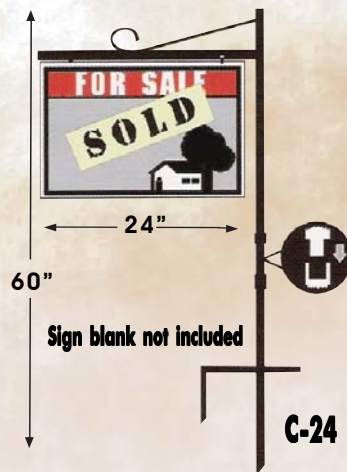

**C-24**

**CRANE SIGN HOLDER**  
 Two part construction for easy installation and handling. Holes 16" apart on center.  
**DISPLAY AREA**  
 24" x up to 40"